

heatray



IRH-E

INFRARED ELECTRIC RADIANT HEATERS



The original IRH-E high-intensity design, engineered to deliver instant heat exactly where it's needed.

Infrared Electric Radiant Heaters

The Heatray IRH-E range delivers instant infrared radiant heat with low-glare. Silent, clean, and emission-free, with a compact design that maximises heat output for its size.

IRH-E heaters are suitable for indoor and outdoor undercover commercial, hospitality, and residential applications. Water-resistant, they can withstand challenging outdoor environments.

A variety of installation options are available, including ceiling or wall mounting, and integration with new or existing structures, including Heatray Umbrellas.

Available in a range of models, to cover a floor area of up to 14m², depending on the model and application.

Energy efficiency

The instant response of infrared radiant heat minimises the warm-up period, reducing overall energy consumption—especially in high-traffic areas. A highly efficient stainless steel internal reflector maximises performance and coverage by directing heat exactly where it's needed.

A range of controls can further enhance efficiency, including remote control, heat output control, zone control (via remote switch), motion sensors, and timers.

Application

- Indoor / outdoor undercover areas
- Areas where combustion gases are not permissible
- Suits wall, ceiling or Heatray umbrella mounting
- Mounting height 2.1m - 3.7m
- Area coverage 2m² - 14m²

Key features

- Instant directional radiant heat
- Anodised aluminium finish available in silver or black
- Spectrum low-glare lamp
- Short~midwave infrared wavelength technology
- Three unit capacities available (1600W, 2000W, 3200W)
- Compact design
- Control: on/off/remote with six heat output settings
- Highly efficient internal reflector
- Silent operation, clean and emission free
- Water resistant IP65 rated for undercover outdoor installation
- Rainshield available for exposed outdoor applications (IRH-E 1600, 2000, 3200 models)
- High-quality, non-corrosive construction offering longevity and ease of maintenance
- Adjustable wall & ceiling brackets
- Individual switching or zone control options
- Motion activation option to cater for smoking and transit areas recommended for energy efficiency

IRH-E

WALL APPLICATION

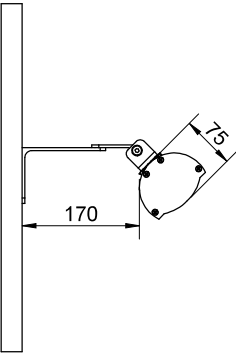

CEILING APPLICATION

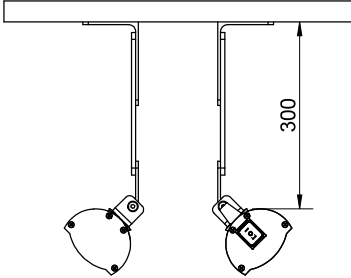

FRONT VIEW: IRH-E 1600/2000

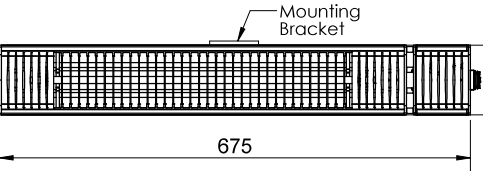

FRONT VIEW: IRH-E 3200

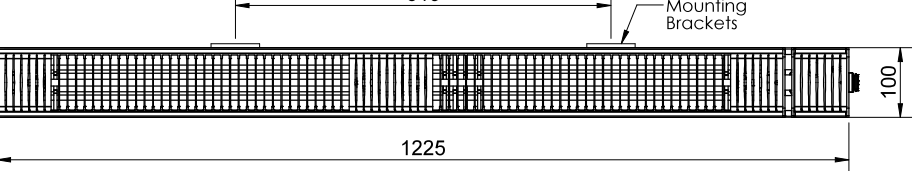

TECHNICAL SPECIFICATIONS

Application	Indoor / outdoor undercover areas
Dimensions	Refer diagrams
Weight	3.1kg (IRH-E 1600 - 2000) / 4.6kg (IRH-E 3200)
Materials	Aluminium grille face, non-corrosive aluminium construction
Finish	Anodised aluminium
Colour	Silver or Black
Mounting	Wall / Ceiling / Umbrella (excl. IRH-E 3200)
Mounting brackets	x1 (IRH-E 1600 - 2000), x2 (IRH-E 3200)
Mounting height	2100 - 3700mm
Area coverage	Refer table following
Heat type	Low-glare
Lamp type	Spectrum short~midwave infrared wavelength
Power	1600W, 2000W, 3200W 220-240V / 1Ph / 50Hz
Range	1500-3500mm forward radius / 120° span

Operation	Instant & directional
Connection	10Amp, 3-pin plug, 1.8m cable (up to 2000W) 15Amp, 3-pin plug, 1.8m cable (3200W)
Protection	Water resistant IP65
Control	On/Off or remote control with 6 heat output settings
Rainshield	– 680L x W160mm (to suit IRH-E 1600 - 2000) – 1230L x W160mm (to suit IRH-E 3200) – Available for outdoor exposed applications – Anodised aluminium in silver or black
Clearances (min)	– Forward clearance from flammables: 1500mm – Ceiling clearance from flammables: 300mm – Rear of unit to wall from flammables: 170mm – End of unit to wall from flammables: 600mm
Control module options	– W375 x H220mm - 1Ph – Available for zone control of up to 2 or 4 heaters – Safety cut-out, circuit protection, low Amp On/Off switching, two-zone control & separate lighting circuit – Relays suitable for BMS control – Optional motion sensors, run-on timers – Optional 2Ph & 3Ph control modules

MOUNTING OPTIONS



Wall mounted



Ceiling mounted



Product label to face upwards



IRH-E Umbrella integration

OPTIONS



Colour: Black



Colour: Silver



Rainshield

IRH-E 1600/2000



IRH-E 3200



MODEL INFORMATION

Model	Power @ 240V		Suggested mounting height (mm)	Floor coverage guide		
	Watts	Amps		Outdoor undercover unprotected (m²)	Outdoor undercover protected (m²)	Indoor (m²)
IRH-E 1600	1600	6.67	2100 - 3000	2 - 3	5 - 6	6 - 8
IRH-E 2000	2000	8.33	2300 - 3200	3 - 4	6 - 7	8 - 10
IRH-E 3200	3200	13.33	2700 - 3700	5 - 6	8 - 10	11 - 14

With efficient operation and elegant design, Heatray products deliver superior infrared warmth in all kinds of environments.



State of Grace, CBD, Melbourne.



Farmer's Daughters, CBD, Melbourne.



Coopers Hotel, Newtown, Sydney.



Lord Lygon, Carlton, Melbourne.



Script Bar, Southbank, Melbourne.



Arintji, Federation Square, Melbourne.



19 Simpson Street
Moorabbin Victoria 3189
Australia

+61 3 8552 8200

info@celmec.com.au

heatray.com.au

heatray

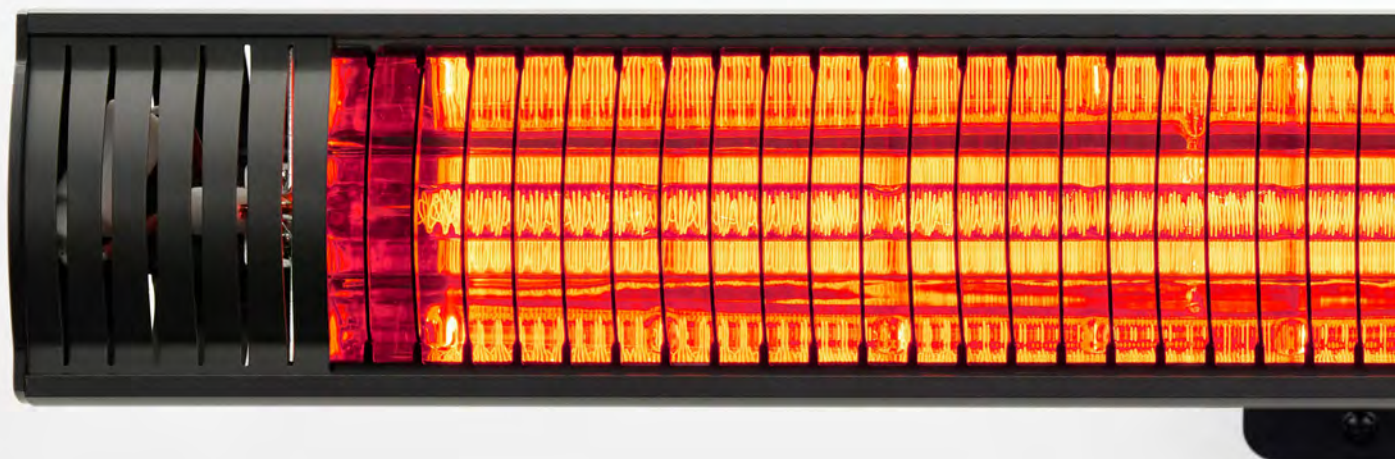

Heatray products are designed,
manufactured and supported
by Celmec – celmec.com.au

